

MAGS Ø1.4" SPOT

MAGS Series Light Fixture. Fixture engages with track system electrically and mechanically via magnetic connection and can be easily moved along the track. Model MAGS-S35 is a DRY rated Magnetic Track, Adjustable Spotlight Aluminum light offered in a Black or white finish. This Light Fixture is CETL listed and contains 1 light using a total of 5 watts. Downlight delivering 360 lumens using an Osram LEDModule with >90 CRI. Choice of 20, 30, 40, or 60 degree beam spreads. Choice of 2700K, 3000K, 3500K, 4000K, 5000K, or 6000K CCT. Dimmable via 24V Volt Remote Driver needed. Spotlight Dimensions are 6.375 inches long x 1.375 inches diameter with a 90 degree tilt and 360 degree rotation.

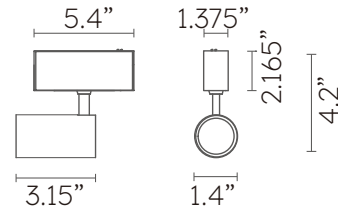

Model Number Configuration

S35

Optics

- D20 - 20°
- D30 -30°
- D40 -40°
- D60 -60°

CCT

- 27 - 2700K
- 30 - 3000K
- 35 - 3500K
- 40 - 4000K

Finish

- BL - Black
- WH - White

Electrical

Voltage	24V
Dimming	Driver dependent
Power	5W
Lumens	360
Power factor	N/A

Environmental

CRI	>90
Environment	Dry
Light Source	LED
Chip	Osram
Life rating	N/A
Listings	C-ETL Listed to UL1598

Mechanical

Installation	N/A
Cord Legth	N/A
Dimensions	6.375"L x 1.375" dia; 90 degree tilt and 360 degree rotation.
Weight	.71 lbs
Material	Aluminum
Finish	Powder Coated

Driver Options

Driver code	PS-96-24-UNI-UNI - Universal input (120-277V) and Universal dimming (ELV, TRIAC, 0-10V) 0-100% dimming. Up to 20 Small or 10 Large Pendants.
--------------------	--

Photometric and Light Distribution

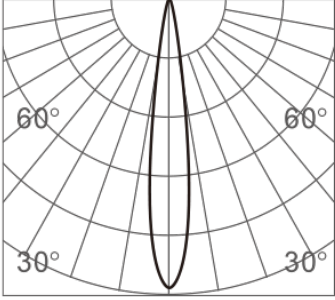
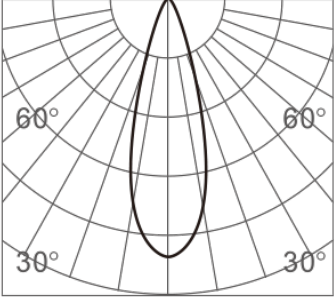
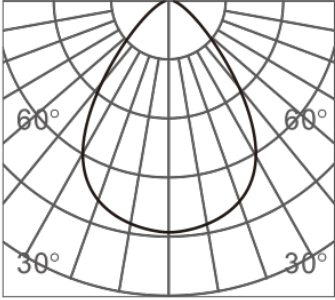
D20				D30						
20°		h(m)	E(lx)	Φ(m)	30°		h(m)	E(lx)	Φ(m)	
		1	3146	Φ0.34			1	3121	Φ0.36	
		2	786	Φ0.68			2	780	Φ0.72	
		3	349	Φ1.02			3	346	Φ1.08	
		4	196	Φ1.36			4	195	Φ1.45	
		5	125	Φ1.71			5	124	Φ1.81	
D40										
40°		h(m)	E(lx)	Φ(m)						
		1	1038	Φ0.70						
		2	259	Φ1.40						
		3	115	Φ2.10						
		4	64	Φ2.80						
		5	41	Φ3.51						